

PRODUCT SPECIFICATIONS

VICTORIAN BACKLESS BENCH - 48" RECYCLED PLASTIC

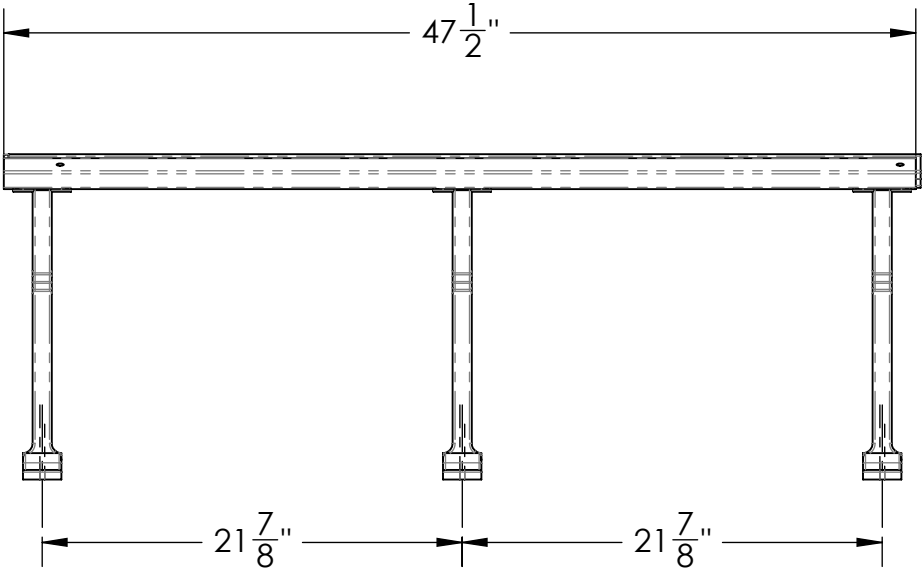
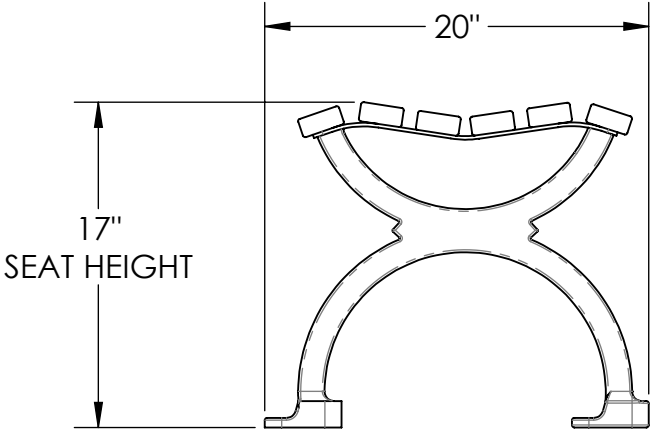
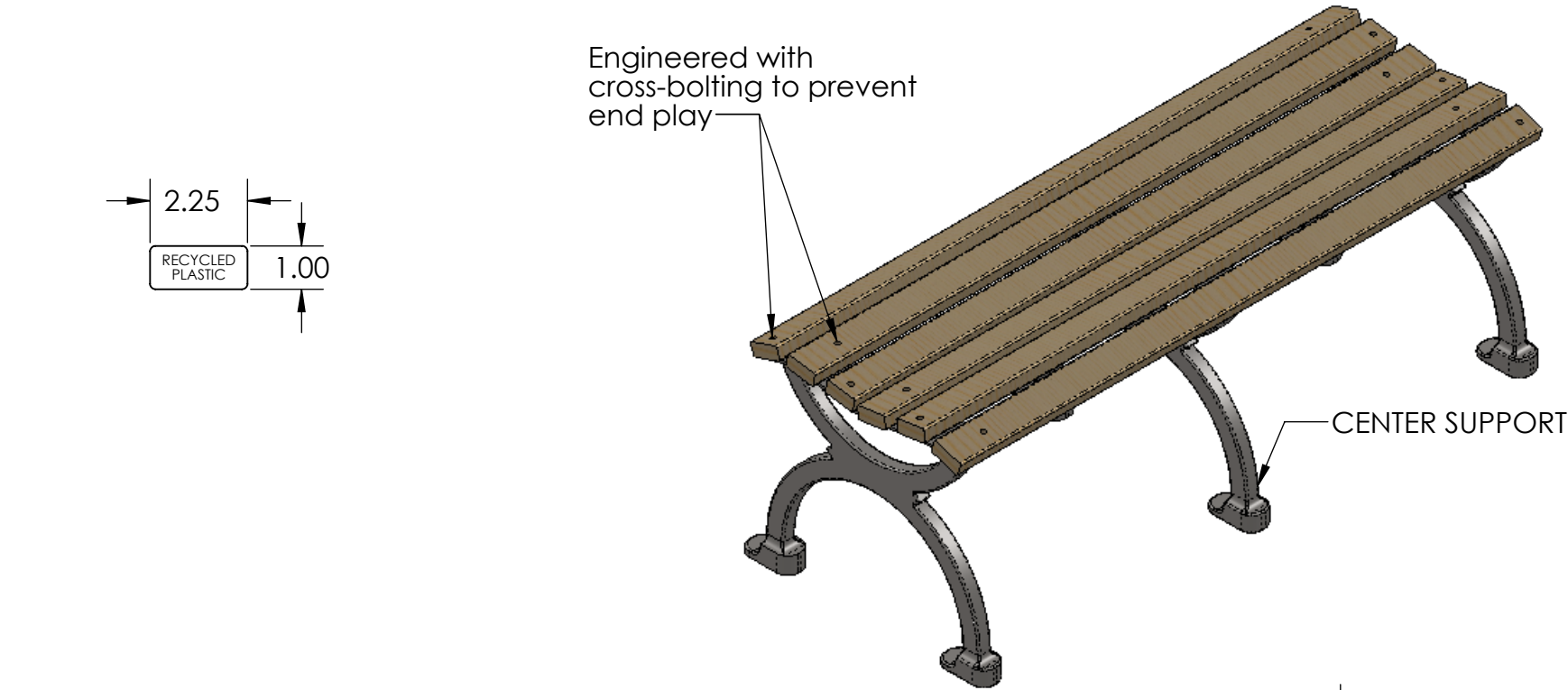

- FRAME**
- **Material:** Cast aluminum poured in permanent molds
 - **Finish:** Electro static powder coating
 - **Color:** Black, White, Green, Tan, Dk. Brown, Dk. Green, Bronze and Blue.
- PLASTIC RAILS**
- **Material:** Polystyrene
 - **Number of Rails:** 6
 - **Finish:** Cedar or Redwood
- HARDWARE**
- **Carriage Bolts:** 1/4"-20 steel zinc plate, yellow dipped
 - **Nuts:** 1/4" steel zinc plate

BOLT DOWN DETAIL
VICTORIAN and RENAISSANCE benches can be drilled for permanent attachment.



DESCRIPTION: VICTORIAN BACKLESS BENCH - 48" RECYCLED PLASTIC				
ADDRESS: 1350 NORTH AVE. SANGER, CALIFORNIA 93657 PHONE: (559) 875-8250 FAX: (559) 875-1491 kingsrivercasting@verizon.net	THE INFORMATION CONTAINED IN THIS DRAWING IS THE SOLE PROPERTY OF KINGS RIVER CASTING. ANY REPRODUCTION IN PART OR WHOLE WITHOUT THE WRITTEN PERMISSION OF KINGS RIVER CASTING IS PROHIBITED.	WEIGHT: 34 LBS	SCALE: 1:10	
		MODEL NUMBER: VBBS - 48"		SIZE B