

PRODUCT SPECIFICATIONS

TOWNSHIP BUS SHELTER

- All metal fabricated parts are etched, phosphatized, preheated, primer powder coated, and final coat electrostatically coated.
- Colors include: Black, Evergreen, Dark Green White, Tan, Dark Brown, and Blue.
- Special order colors available.
- This product can ship either knocked down or assembled.



(8) Ø3/4 THRU MOUNTING HOLES

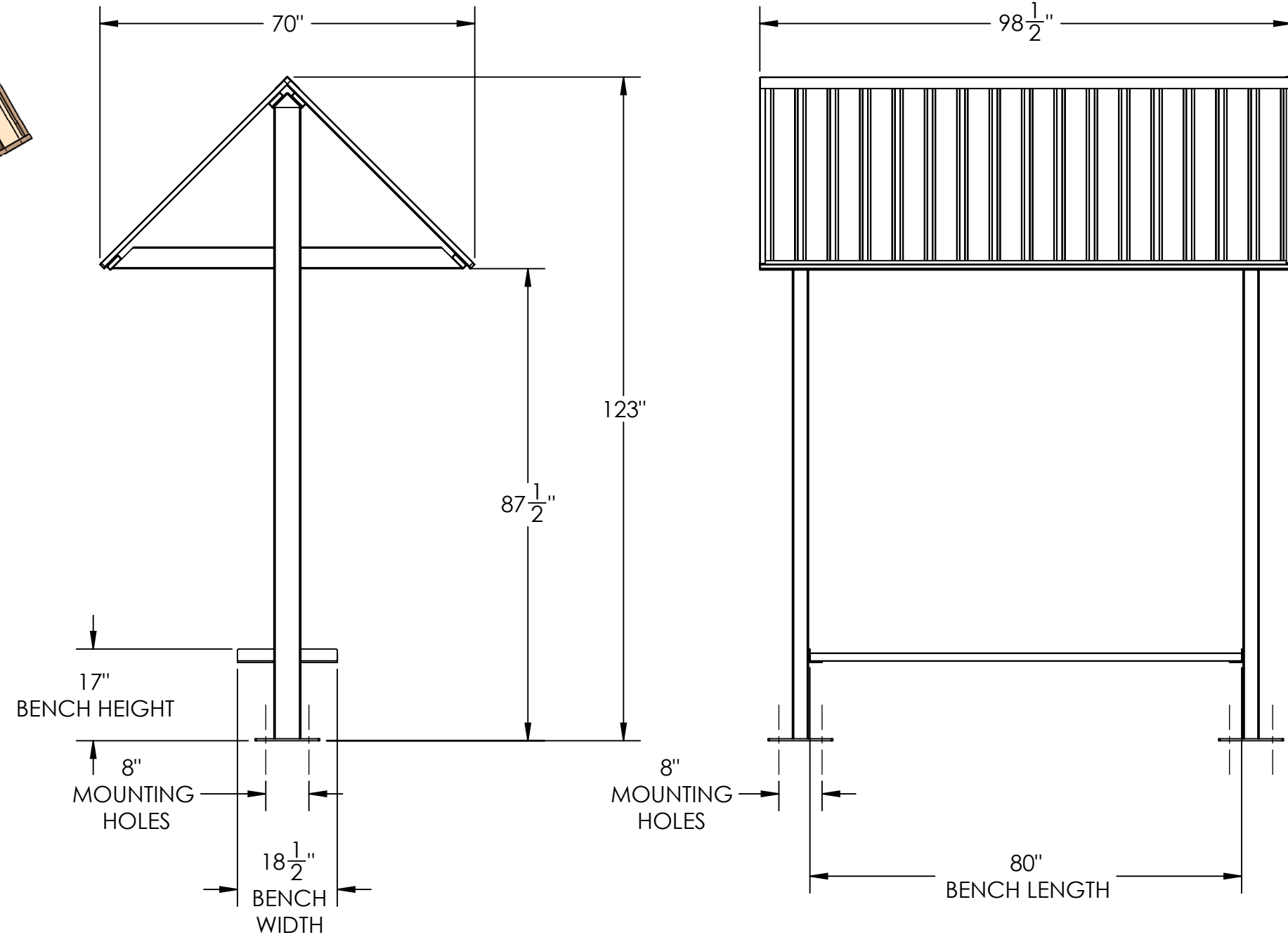

NOTE:
It is not recommended to locate anchor bolts until the shelter is in place. Anchor bolts not included.



DESCRIPTION:		TOWNSHIP BUS SHELTER	
ADDRESS: 1350 NORTH AVE. SANGER, CALIFORNIA 93657 PHONE: (559) 875-8250 FAX: (559) 875-1491 kingsrivercasting@verizon.net	THE INFORMATION CONTAINED IN THIS DRAWING IS THE SOLE PROPERTY OF KINGS RIVER CASTING. ANY REPRODUCTION IN PART OR WHOLE WITHOUT THE WRITTEN PERMISSION OF KINGS RIVER CASTING IS PROHIBITED.	WEIGHT: 560 LBS	SCALE: 1:25
		MODEL NUMBER: TBS	SIZE B